

Explosion-Protected Compact Sheet Steel Light Fitting for Zone 2 and Zone 22 Series nD3084...

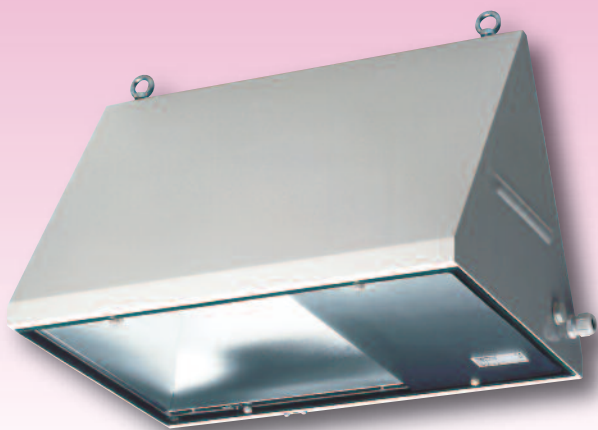

Applications:

Hazardous locations, of Zones 2 (gas atmosphere) and 22 (dust atmosphere), production halls and warehouses, in industrial sectors, workshops and chemical factories etc..

Design:

Housing: Sheet steel powder coated in light grey (RAL 7035); operating components built in. Stainless steel housing upon request and at extra charge.

Reflector: Surface finished purest aluminium.

Glass cover: Frameless safety glass pane, hinged.

Central locking system: Operated by a 5mm allen key. Hinges on the opposite side.

Connection: 3-pole terminal up to 2,5mm² (up to 6mm² upon request)

Cable entry: 1 cable gland and 1 plug M25 x 1,5 on one side of the housing.

Mounting: Pendant with 2 eyebolts M6 (incl.).

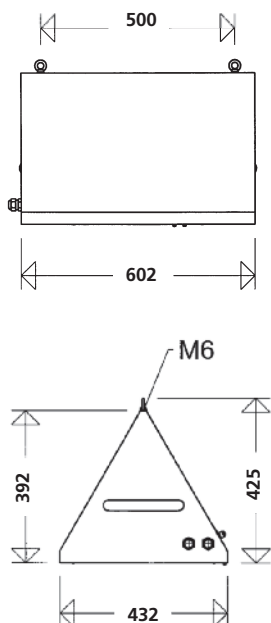

SCHUCH Quality - your advantage:

- **robust industrial model for reliable long-term use**
 - robust sheet steel housing with high grade powder coating for excellent corrosion protection (stainless steel version upon request)
 - frameless, 5mm safety glass pane
 - sturdy central locking system with internal stainless steel hinges
- **easy to install and to maintain**
 - suspension mount by means of chains or steel cables
 - Original SCHUCH central locking system with hinged safety glass pane, for easy connection and lamp replacement and for easy access to connection compartment
- **optimized mirror system with a high degree of light efficiency**
- **for applications in different ambient conditions**
 - for various types of lamps (ellipsoid, tubular shaped and induction lamps)
 - for gas and dust hazardous areas (Zones 2 and 22)
 - wide range of Permissible ambient temperatures -20°C up to +50°C (special version up to +60°C)
 - especially suited for dust atmospheres due to special dust repellent design (Zone 22)

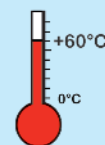

nD3084...



II 3 G Ex nR IIC T3/T4

II 3 D Ex tD A22 T130-170°C

IP65



TÜV 05 ATEX 2723

Other approvals:

GOST-R/ROSTECH-NADZOR (Russia)

Ignition protection: nR

Marking:

II 3 G Ex nR IIC T3/T4 (Zone 2)

II 3 D Ex tD A22 IP65 T130-170°C (Zone 22)

Permissible ambient temperature:

-20°C up to +50°C/60°C

(special version up to +60°C)

Rated voltage:

220-240V AC/DC, 0 or 50/60Hz.

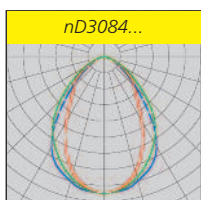

Type	Article no.	Temp.-cl./ T _{max}	Adm. amb. t.	Lamps W	Weight ca. kg ²⁾
for tungsten halogene lamps socket E40					
nD3084/500 QT	30842 0014	T4/130	40°C	QT 500	10,5
for high pressure lamps, socket E40					
nD3084/250	30842 0001 ¹⁾	T4/130	50°C	HME 250	14,1
nD3084/400	30842 0003 ¹⁾	T3/160	50°C	HME 400	16,3
nD3084/250 HI	30842 0005 ¹⁾	T4/130	50°C	HIE/HIT 250	14,2
nD3084/400 HI	30842 0007 ¹⁾	T3/170	50°C	HIE/HIT 400	16,4
nD3084/250 HS	30842 0011 ¹⁾	T4/130	50°C	HSE/HST 250	16,0
nD3084/400 HS	30842 0009 ¹⁾	T3/160	50°C	HSE/HST 400	16,4

1) Uncomp., article nos. for comp. see price list

2) weights without packing material

Advantages of the induction-type lighting system "ENDURA":

- extremely long life (60,000 hrs)
- flicker-free instant start within < 0.1 sec., suitable as emergency illumination
- high luminous flux (12.000lm) beside high efficiency (80lm/W)
- high quality colour reproduction Ra > 80
- none-flickering light output due to high frequency pulsing > 250kHz
- instant reignition with almost full light output
- constantly high luminous flux over a large range of mains voltage, suitable for D.C. voltage
- low luminous flux decline during life cycle
- low ignition temperature and constantly high luminous flux over a wide temperature range, suitable for low temperatures at outdoor areas, down to -30°C / -40°C
- maintenance-free

nD3084... ENDURA



II 3 G Ex nR II T4

II 3 D Ex tD A22 T80°C

IP65



Applications:

Especially at places which are not easily accessible and where a lamp replacement may be a costly matter or if generally long maintenance intervals are wanted for cost saving

Permissible ambient temperature:

-30°C up to +40°C

Rated voltage:

220-240V AC, 154... 276V DC
0 or 50/60Hz.

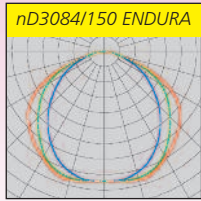

Type	Article no.	Temp.-cl./ T _{max}	Adm. amb. t.	Lamps W	Weight ca. kg ¹⁾
nD3084/150 ENDURA	30842 0013	T4/80	40°C	LMT-SIHF 150	12,5

1) Weights without packing material.

nD3084... H60



II 3 G Ex nR II T3/T4

II 3 D Ex tD A22 T130-165°C

IP65



for ambient temperatures up to +60°C

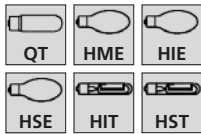

Type	Article no.	Temp.-cl./ T _{max}	Adm. amb. t.	Lamps W	Weight ca. kg ³⁾
for tungsten halogen lamps, socket E40					
nD3084/300 QT H60 ²⁾	30842 0115	T4/130	60°C	QT 300	10,5
nD3084/500 QT H60	30842 0114	T3/160	60°C	QT 500	10,5
for high pressure lamps, socket E40					
nD3084/250 H60	30842 0101 ¹⁾	T3/140	60°C	HME 250	14,0
nD3084/250 HI H60	30842 0105 ¹⁾	T3/140	60°C	HIE/HIT 250	16,0
nD3084/250 HS H60	30842 0111 ¹⁾	T3/140	60°C	HSE/HST 250	16,0

1) Uncomp., art. nos. for comp. see price list
2) Rated voltage 120V AC/DC

3) Weights without packing material.

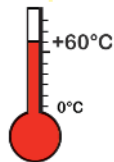

! Further Series / Equipment

- with stainless steel housing, powder coated
- with terminals up to 6 mm², 5poles
- with cable entries M20 x 1,5



Accessories / Spare Parts

Type	Article no.	
3070/010	90073 9000	spare glass pane clip closure system (until March 2005)
3070/011	90073 9003	spare glass pane for central locking system (starting April 2005)
2537	90117 9000	ex-proof plastic cable gland M25 x 1,5
2538	90118 9000	ex-proof plug M25 x 1,5